

AI

Foxtail Pines

F1 lot 16

600 Wheat Way

Ph (719) 836-4267 Fax (719) 836-4266

Foxtail Pines

POSAL SYSTEM F1, L16

PARTMENT

0

PLEASE CHECK ONE: NEW REPAIR

IF REPAIR, DESCRIBE _____

TAX SCHEDULE # 36979 DRIVEWAY PERMIT # F8900

OFFICE USE ONLY	
FEE PAID <u>\$400</u>	CK# <u>7253</u>
DATE RECEIVED <u>9/9/05</u>	
RECEIVED BY <u>[Signature]</u>	
PERMIT # <u>05RES-00303</u>	
DATE ISSUED <u>9/22/05</u>	

1. Applicant's Name MICHAEL A. STELLING
 Address P.O. Box 1390
 City FAIRPLAY State CO Zip 80440
 Phones: Home 719-836-9898 Work 719-839-1383 Fax 719-836-9898

Owner's Name SAME AS ABOVE
 Address _____
 City _____ State _____ Zip _____
 Phones: Home _____ Work _____ Fax _____

2. PROPERTY INFORMATION

Subdivision/Legal Description LOT 16 FILING 1 FOXTAIL PINES
 (Must List Only One Lot/Parcel)
 Property Physical Address 600 WHEAT WAY - ok per B.D. map
 Acreage 2.0 # Bedrooms 3 Type of Building SINGLE FAMILY RESIDENCE

3. WATER INFORMATION

Private well Public system _____ Other _____
 Is property close to a stream? Y N If Yes, distance _____
 Is property close to a wetland, drainage, or floodplain? Y N If yes, distance _____
 If in a floodplain, list flood zone determination per FEMA mapping _____

4. SEPTIC SYSTEM TO BE INSTALLED BY:

Name MICHAEL A. STELLING License # 43

THE UNDERSIGNED ACKNOWLEDGES THAT THE ABOVE INFORMATION IS TRUE AND CORRECT AND THAT FALSE INFORMATION WILL NEGATE AND INVALIDATE THE APPLICATION AND/OR THE SUBSEQUENT PERMIT. A SEPTIC PERMIT IS NOT TRANSFERABLE TO ANY OTHER LOT. THIS PERMIT IS VALID FOR ONE YEAR AFTER THE DATE OF ISSUANCE.

SIGNATURE Michael A. Stelling DATE 9-9-05

OFFICE USE ONLY: FINAL INSPECTION AND APPROVAL INFORMATION

TANK CAPACITY 1250 / 2 Comp / 316
 ABSORPTION AREA 1080 sq ft DIMENSIONS Mounded 12" (18x60')
 SYSTEM INSTALLED BY STELLING #43
 SYSTEM APPROVED BY HEALTH SPECIALIST BW O'Connor DATE 5/16/06

FINAL PERMIT APPROVAL DATE _____
 DRIVEWAY PERMIT: APPROVED INSPECTOR Jim Linn OK@ 5/16/06 DATE 8/29/00

APPROVED

48
18

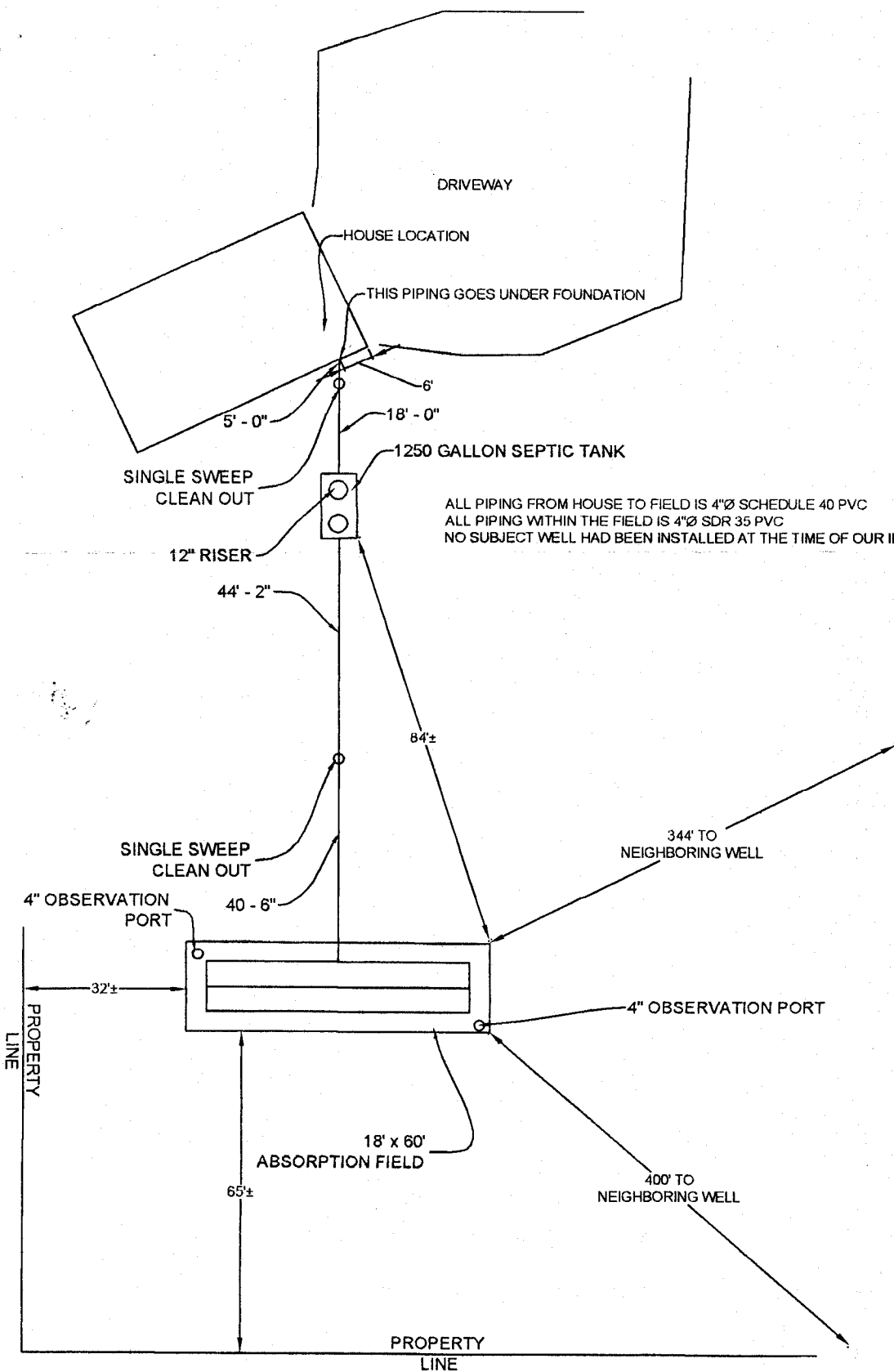

ALL PIPING FROM HOUSE TO FIELD IS 4"Ø SCHEDULE 40 PVC
 ALL PIPING WITHIN THE FIELD IS 4"Ø SDR 35 PVC
 NO SUBJECT WELL HAD BEEN INSTALLED AT THE TIME OF OUR INSPECTION

LEAD, LLC

Fairplay, Colorado • (719) 836-7120 (phone) • 836-7115 (fax)
 P.O. Box 1739 • 970 Castello • Fairplay, Colorado 80440



**Disposal System
 As-Built**

Scale: Shown	Sheet: DRAWING 1
Proj. No.: PC1082005	Date: MAY 22, 2006

SEWAGE DISPOSAL PERMIT

PARK COUNTY HEALTH DEPARTMENT

P.O. BOX 216

FAIRPLAY, CO. 80440 (719) 836-4267

Date Issued: 09/22/2005 Permit Number: 05RES-00000-00303 Schedule No: R0036979

TO CONSTRUCT, ALTER, REPAIR OR MODIFY AN INDIVIDUAL SEWAGE DISPOSAL SYSTEM IN PARK COUNTY COLORADO.

ISSUED TO: STELLING MICHAEL A
P O BOX 1390
FAIRPLAY, CO 80440-1390

ENGINEER: State
JOB NO: PC1082005

LEGAL DESCRIPTION: T10 R77 S06 NE4 FOXTAIL PINES FILING 1 LOT 016

WASTE DISPOSAL SYSTEM TO BE INSTALLED BY:

THIS PERMIT IS NOT TRANSFERABLE, AND IS ISSUED FOR THE PERIOD OF ONE YEAR (UNLESS OTHERWISE STATED BELOW) IN ACCORDANCE WITH PARK COUNTY INDIVIDUAL SEWAGE DISPOSAL REGULATIONS.

DATE OF EXPIRATION: 09/22/2006

ENVIRONMENTAL HEALTH SPECIALIST

SEPTIC SYSTEM DIMENSIONS FOR A 3 BEDROOM HOUSE. ANY FUTURE ADDITION OF BEDROOMS WILL REQUIRE A LEACHFIELD AND POSSIBLY INCREASED SEPTIC TANK CAPACITY.

TANK: 1250 GAL, 2 COMP w/MOD #316 SCREENED DOSER

List of Conditions:

- 18' x 60' Field; Excavate 1 ft deep on downhill wall. Extend observation ports to the bottom of the excavation.
- MUST FOLLOW ALL REQUIREMENTS IN THE CURRENT ISDS REGULATIONS!
- Install clean out 5' from house.
- Install clean out in field.

- Must maintain 200' from well to leach field.
- This system was engineered by John J Littlehorn of Littlehorn Engineering & Design, LLC.
- Refer to engineer's design for installation instructions.

PCEHD will conduct final inspection. This office shall be notified by applicant 48 hours in advance. (This does not guarantee that inspections will be made within 48 hours.)

ADDITIONAL REQUIREMENTS: 1.) Well must be installed prior to calling PCEHD for final system inspection. 2.) A copy of the well log and well permit must be submitted prior to final inspection. 3.) A final letter of approval from the engineer (if designed by an engineer) observing the installation of this system and an "as-built" must be submitted prior to final approval. 4.) A minimum SDR35 is required. 5.) Mirafi Filter Fabric is required. 6.) Schedule 40 is required under all driveways.

The Health Officer shall assume no responsibility in case of failure or inadequacy of a sewage disposal system, beyond consulting in good faith with the property owner or representative. **THE PROPERTY OWNER WILL BE RESPONSIBLE FOR THE ACCURATE LOCATION OF ALL PROPERTY LINES.** Access to the property shall be authorized at a reasonable time to make necessary inspections